



**Whitehall Manufacturing®**  
Manufacturer of Healthcare and Rehabilitation Products since 1946

**BestCare®**  
Patients, Not Prisoners®

**Healthcare and Ligature  
Resistant Products**

Division of  
Acorn Engineering Company®



A MEMBER OF



## Whitehall Ligature Resistant Faucet with pushbuttons and Valve

Model WH3373  
& WH3374



\*\*U.S. DESIGN PATENTED

WH3374

Fixture May Show Some Available Options

### Ligature Resistant Faucet

**The Ligature Resistant Faucet** is designed and developed to retrofit existing lavatories or it can be specified for new design. The Ligature Resistant Faucet is arranged to be mounted to the deck of the lavatory. Faucet assembly requires (3) 1-5/16" to 1-1/2" diameter holes on 4" or optional 8" centerset. Conical faucet is chrome plated brass and provides vandal and suicide resistance.

**Valve** is an Air-Control pneumatically operated, pushbutton valve using atmospheric air. Hemispherical pushbuttons are vandal-resistant and require less than 5 pounds of force to activate valve. Valve is metering with non-hold open feature. Metering valve timing range is 0-60 seconds. Valve includes a 0.7 GPM flow control and can be remotely located up to 10 feet from the operating pushbutton.

**Optional** -MXTP Mixing Valve option delivers tempered water flow by compensating for pressure and temperature fluctuations. Valve is to be field set to 105 Fahrenheit and includes strainers and integral checks. Operating range is 30 to 100 psi.

**Fixture is ADA Compliant.** Unit conforms with ADA requirements for accessibility when installed correctly. Compliance is subject to the interpretation and requirements of the local code authority.

### GUIDE SPECIFICATION

Provide and install Ligature Resistant Faucet assembly (specify model number and options). Faucet escutcheon shall be fabricated from 14 gage type 304 stainless steel and shall have a satin finish. Faucet valve shall be Air-Control, metering, non-hold open type. Assembly shall include 0.7 GPM flow control, hot and cold hemispherical pushbuttons, pushbutton sleeve and faucet connections.

Please visit [www.whitehallmfg.com](http://www.whitehallmfg.com)  
for most current specifications.



Recyclable  
Product



Water  
Conserving  
Product

Complies  
with the  
following  
standards:



Federal  
Public Law  
111-380  
(No Lead)



Whitehall Mfg. • P.O. Box 3527 • City of Industry, CA 91744 • (800) 782-7706 • (626) 968-6681

**WH3373**

Updated: 09/07/2023



**MODEL NUMBER AND OPTIONS SELECTION:**

**BASE MODEL NUMBER**

- |                                     |  |
|-------------------------------------|--|
| <input type="checkbox"/> WH3373     | Ligature Resistant Faucet with Air-Control Valve Assembly, Single Temp with 4" Centerset |
| <input type="checkbox"/> WH3374     | Ligature Resistant Faucet with Air-Control Valve Assembly, Hot & Cold with 4" Centerset  |
| <input type="checkbox"/> WH3373-8IN | Ligature Resistant Faucet with Air-Control Valve Assembly, Single Temp with 8" Centerset |
| <input type="checkbox"/> WH3374-8IN | Ligature Resistant Faucet with Air-Control Valve Assembly, Hot & Cold with 8" Centerset  |

**OPTIONS:**

- ☐ WHST70-12 ASSE 1070 Compliant Hot & Cold, Temperature / Pressure Balancing Mixing Valve

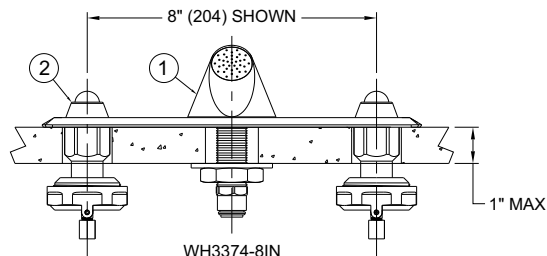

WH3374-8IN

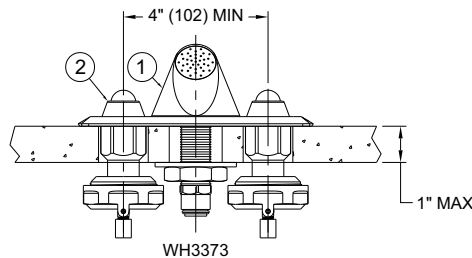

WH3373

**NOTES:**

1. CONICAL LIGATURE RESISTANT SPOUT
2. LIGATURE RESISTANT HEMISPHERICAL PUSHBUTTONS
3. ESCUTCHEON PLATE
4. AIR CONTROL VALVE ASSEMBLY, HOT AND COLD
5. AIR CONTROL VALVE ASSEMBLY, SINGLE TEMPERATURE
6. CHIECKSTOP/STRAINER ASSEMBLY
7. 1/2" NPS INLET FLEX HOSE

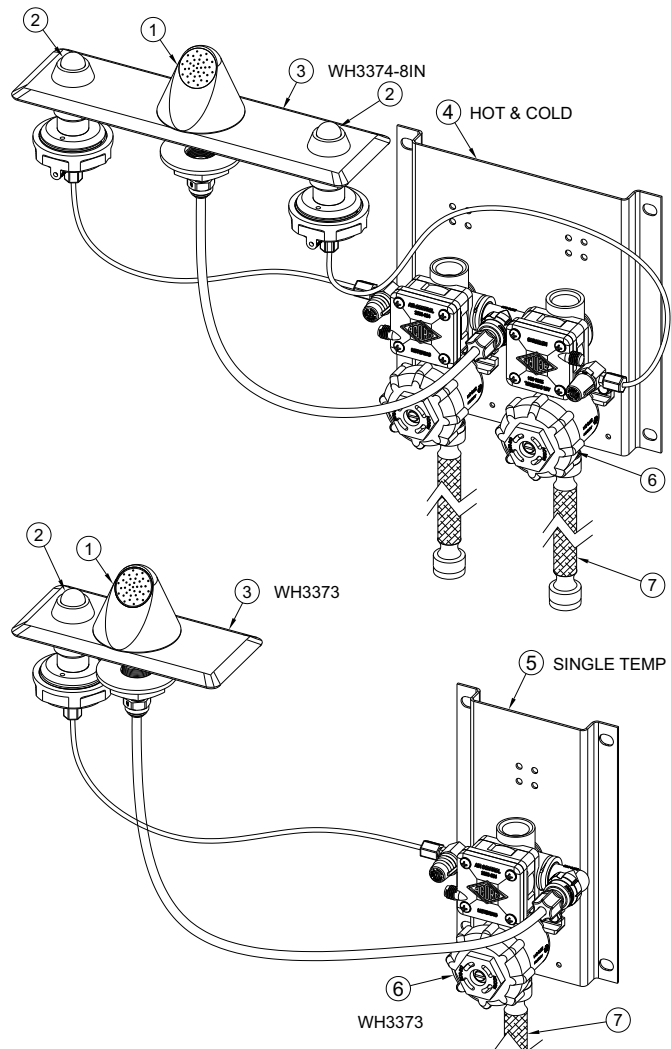

**DISCLAIMER:**

This product is designed to decrease the probability that it may be utilized as an apparatus for ligature. It is not a replacement for professionals who are trained in the proper evaluation, management and supervision of persons at risk of suicide.

**⚠ WARNING: Cancer and Reproductive Harm - [www.P65Warnings.ca.gov](http://www.P65Warnings.ca.gov)**

**SELECTION SUMMARY & APPROVAL FOR MANUFACTURING**

Model Number & Options	Quantity
Company	Date
Contact	Title
Approval for Manufacturing/Signature	

All dimensions are nominal and subject to manufacturer's change without notice. Whitehall assumes no responsibility for use of void or superseded data. Whitehall Manufacturing®, Member of Morris Group International. Please visit [www.whitehallmfg.com](http://www.whitehallmfg.com) for most current specifications.