



# BestCare®

By Whitehall Manufacturing®



HANDS FREE  
WHICH AIDE IN  
INFECTION PREVENTION

## LIGATURE-RESISTANT FLUSH VALVE COVER AND SENSOR OPERATED FLUSH VALVE ACTIVATION



PROTECT YOUR  
PATIENTS WHERE RISK  
IS A CONCERN.

DESIGNED WITH  
VANDAL-RESISTANT  
HARDWARE

Sloped edges

Sensor

Electrical  
override button



Sloped edges

Vandal-resistant screws

MODEL WH2802SLPT-SO:  
Includes both flush valve cover  
and sensor operated flush activation

### FLUSH VALVE COVER:

- 16 gage stainless steel construction
- White Enviro-Glaze® powder coat
- Furnished with six removable wall brackets secured with vandal-resistant screws

### SENSOR OPERATED FLUSH VALVE ACTIVATION:

- Flush Valve includes a ligature-resistant sensor panel with an electrical override button, union angle stop and vacuum breaker
- Exposed parts are polished chrome plated

\* Recommended for toilets with top supply. Toilet not included.

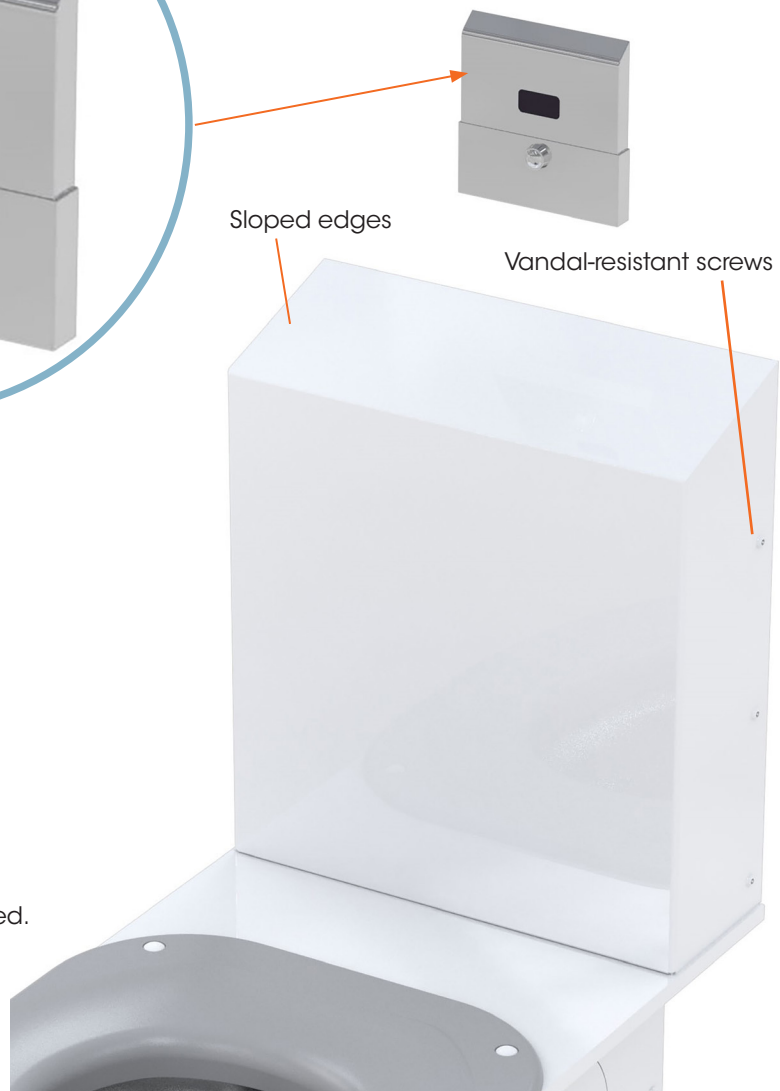

AFFORDABLE



QUICK INSTALLATION



AESTHETICS



UNIVERSAL DESIGN



RETROFIT &  
NEW CONSTRUCTION

# BestCare®

## LIGATURE-RESISTANT FLUSH VALVE COVER AND SENSOR OPERATED FLUSH VALVE ACTIVATION

**NEW**

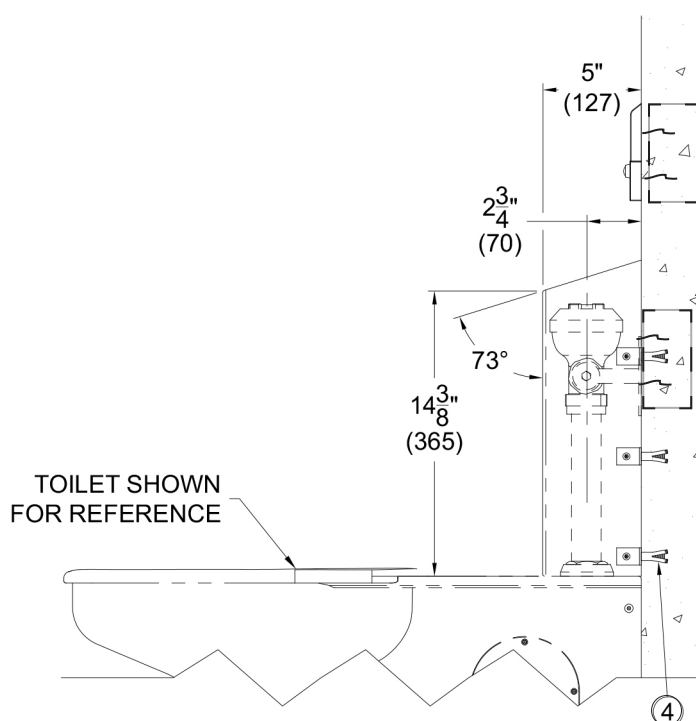
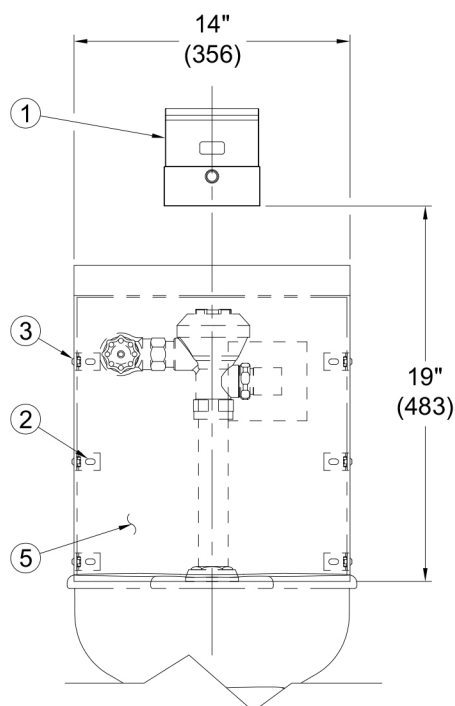

- 1.) Ligature-resistant hardwire sensor panel with override pushbutton
- 2.) Mounting clips
- 3.) Vandal-resistant fasteners
- 4.) Wall anchors
- 5.) Ligature-resistant flush valve cover

\* Recommended for toilets with top supply. Toilet not included.



**Whitehall Manufacturing**  
Manufacturer of Healthcare and Rehabilitation Products since 1946

CONTACT US:

**Phone Number:**

Tel: (800) 782-7706 or (626) 968-6681

Fax: (626) 855-4862

Email: [info@whitehallmfg.com](mailto:info@whitehallmfg.com)

[www.whitehallmfg.com](http://www.whitehallmfg.com)

**Street Address:**

15125 Proctor Avenue

City of Industry, CA 91746 USA

L1001447  
0719



**MORRIS GROUP**  
INTERNATIONAL

[www.morrisgroup.co](http://www.morrisgroup.co)